

Code.No: R05210305**R05**

II B.TECH – I SEM EXAMINATIONS, NOVEMBER - 2010
MACHINE DRAWING
(COMMON TO ME, MECT, MEP, AME)

Time: 3 hours**Max.Marks:80**

Answer any two questions from PART-A
PART-B is compulsory

- - -

PART – A

1. Draw hexagonal headed bolt and nut with dia of bolt as 30 mm. [15]
2. Show different types of key heads at least four. [15]
3. Draw the sectional front view and top view of double row, zig – zag combined lap and butt joint if the rivet diameter as 16 mm. [15]

PART – B

4. Draw the sectional front view (left half in section) and right side view of the assembled stuffing box from the given figure and part list. [50]

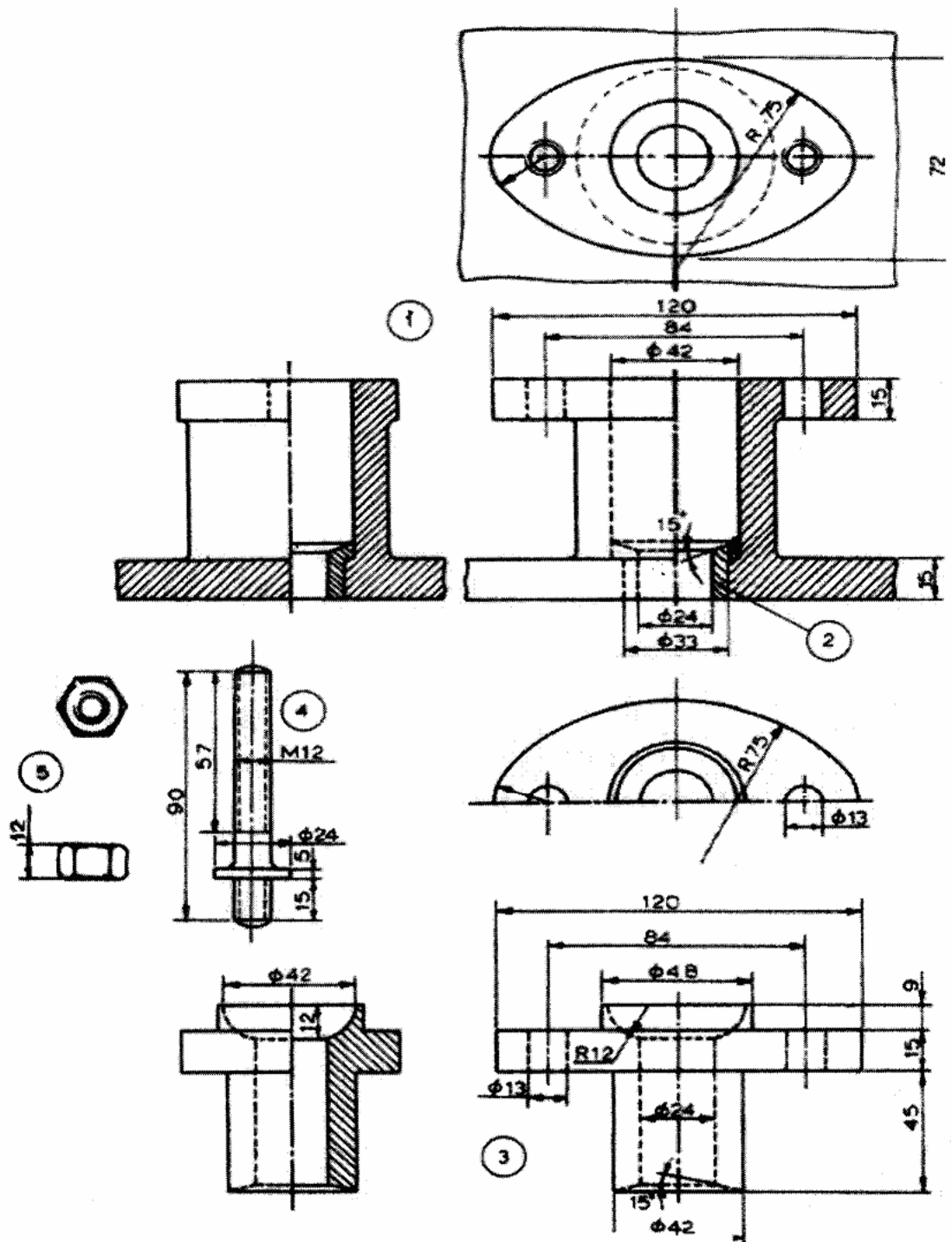

Part List

Part No.	Name	Material	Quantity
1	Body	C.I.	1
2	Bush	Brass	1
3	Gland	Brass	1
4	Stud	M.S.	2
5	Nut	M.S.	2